

Parts Index

* not to scale

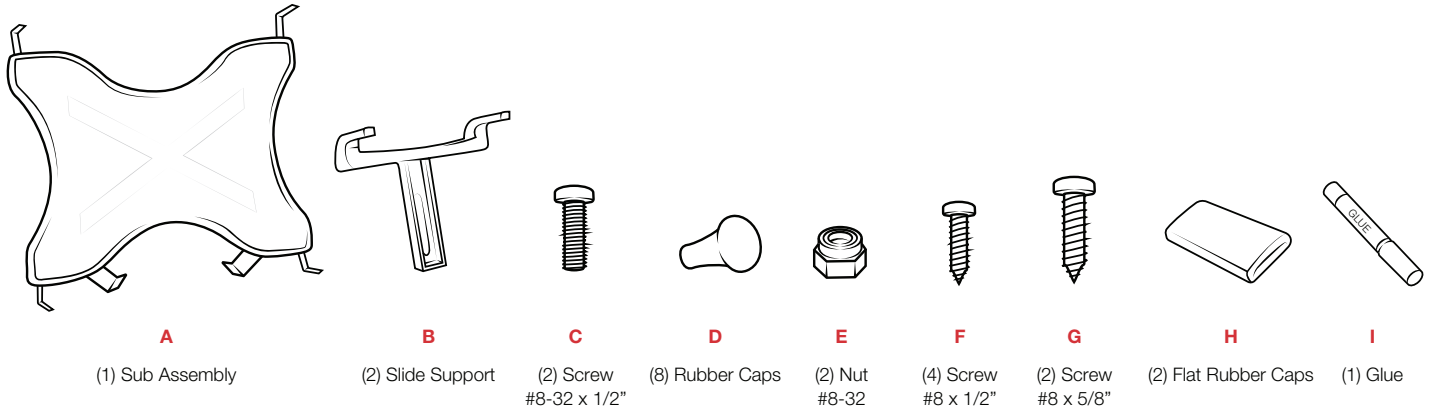

1 Attach **(D)** and **(H)** Rubber Caps to each prong on **(A)** Sub Assembly. Use optional **(I)** Glue for a secure hold.

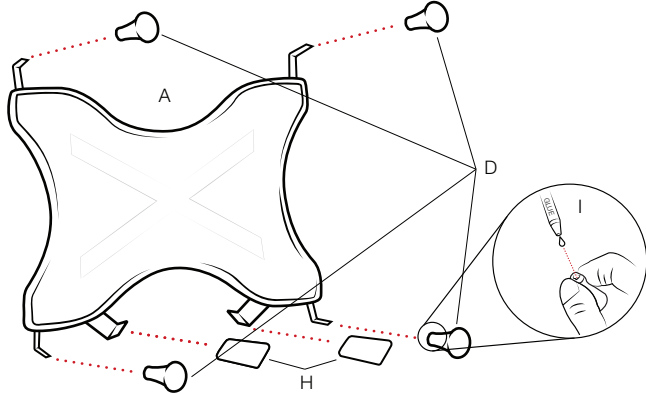

2 When attaching ball, use the **(F)** 1/2" Screws for metal or round ball adapters. Use **(G)** 5/8" Screws for composite diamond ball adapters.

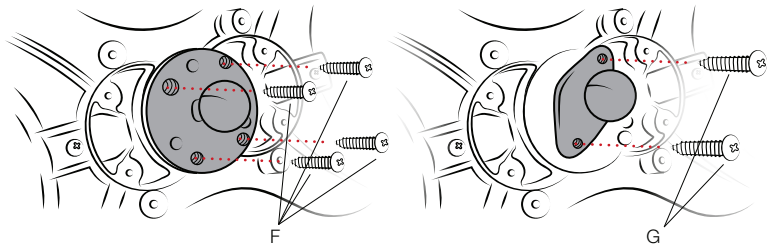

3 Position **(E)** Nut face up at the bottom of slotted hole on **(B)** Slide Support. Carefully set the support into the bottom hole of **(A)** Sub Assembly at an angle to prevent the nut from falling inside the assembly. Hold the support at that angle for Step 4.

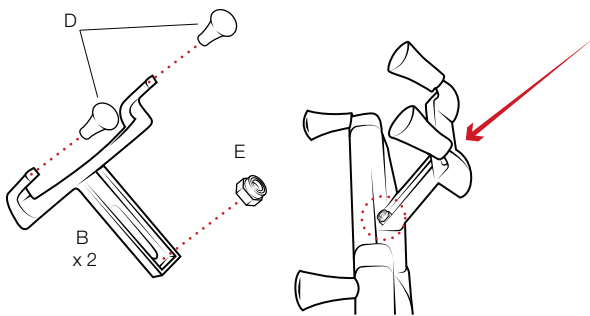

4 While holding the slide support, insert **(C)** Screw at angle to line up with **(E)** Nut and thread by hand until locked in with threads. Straighten the support and continue tightening the screw. Repeat Steps 3 & 4 for second **(B)** Slide Support.

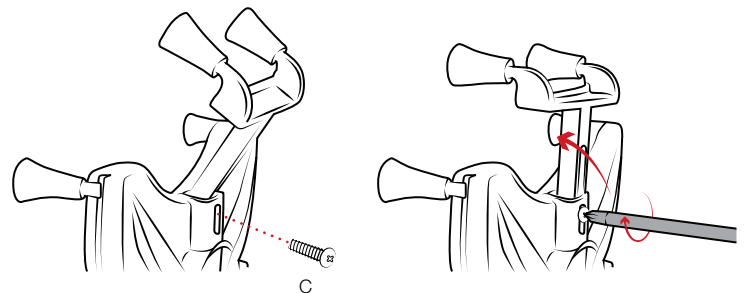

Patented RMR-INS-UN9



Safety Precaution

Do not install this product near or over an airbag deployment area or in a location that obstructs the driver's vision or interferes with vehicle operation. National Products, Inc does not assume responsibility or liability for any such personal injury, death or property damage.